

BUCKET LINKAGE SHEARS

BLS Models

SPECIFICATIONS

MODEL	(1) EXCAVATOR WEIGHT APPROXIMATE 3rd Member		(2) ATTACHMENT WEIGHT APPROXIMATE		(3) JAW OPENING		JAW DEPTH	
	(lbs)	(m tons)	(lbs)	(kg)	(in)	(mm)	(in)	(mm)
BLS 40	40,000 – 65,000	18-30	2,900	1,315	15 – 18	381 – 457	18	457
BLS 80	70,000 – 100,000	32-45	3,500	1,588	17 – 20	432 – 508	19.5	495

(1) Excavator weight recommendation is based on standard excavator weights and boom and/or arm lengths. All applications must be approved by LaBounty prior to sale.

(2) Attachment weight can vary depending upon mounting bracket, and any options installed on the shear.

(3) Jaw opening can vary depending upon the excavator's bucket cylinder stroke and linkage configuration.

NOTE: Weights, dimensions, operating specifications listed on this sheet are subject to change without notice. Where specifications are critical to your application, consult LaBounty.

LaBounty® BLS Bucket Linkage Shears are specifically designed for cutting light to medium size material such as structural steel, pipe, rebar, tires and concrete. Ideal applications for the BLS 40 and BLS 80 include scrap processing and demolition clean up.

Use Excavator Cylinder, and Linkage.

BLS shears use the excavator bucket cylinder and linkage, making installation and operation quick and simple. Because no modifications are made to the linkage, interchanging attachments such as buckets, or LaBounty Concrete Pulverizers, Grapples and Wood Shears is possible. In addition, BLS Shears mount directly to the pads already in use with those attachments. The rear bracket and connecting link allow for some variation in mounting pad location to facilitate interchange from one excavator to another or one attachment to another.

Some BLS mounts may be configured to work on several excavator makes and models. Please consult LaBounty or your authorized LaBounty Distributor for more information.

No Additional Hydraulics Required.

The BLS 40 and BLS 80 pin in place of the excavator bucket, eliminating the need for additional hydraulics. A mounting pad welded to the bottom of the excavator arm attaches to the shear's rear mounting bracket via the connecting link.

BLS Bucket Linkage Shear Components

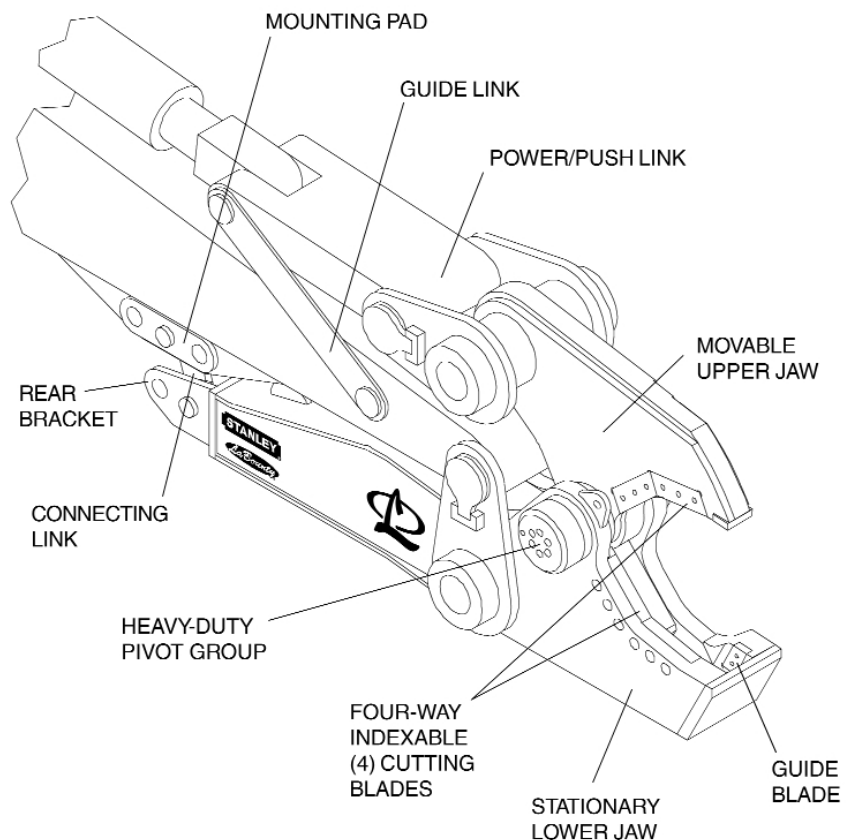

BLS SHEAR OPTIONS, ACCESSORIES AND WEAR PARTS

The items listed below are available for all BLS Bucket Linkage Shears

- 4-way Indexable, Replaceable Cutting blades
- Bold-in Replaceable Guide Blade
- Weld-in Replaceable Piercing Tip
- Weld-in Replaceable Upper Wear Plate
- At-Factory Upgrade and Rebuilding Services

Multiple Machine Mount Capability. When an order is placed for a LaBounty Bucket Linkage Shear, the unit will be manufactured specifically to pin on the excavator for which it was ordered. However, BLS Shears may be retrofitted to various excavator brands within each weight class. Please consult the LaBounty Inside Sales Department to determine compatibility and price of Installation Kits.

BLS Bucket Linkage Shear Operation

The LaBounty® BLS 40 and BLS 80 Bucket Linkage Shears replace the bucket of an excavator and operate with the same controls – no additional hydraulics are required. The bucket dump control operates the shear open and the bucket curl operates the shear close.

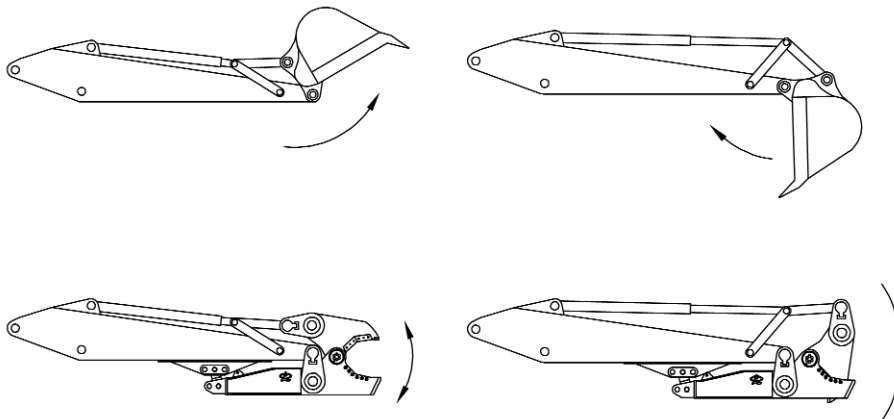

Bucket DUMP = Shear OPEN

Bucket CURL = Shear CLOSE

SAFETY FIRST! Please read, observe and follow the safety precautions found in the LaBounty Operations, Safety and Maintenance Manual shipped with your attachment.

Call your Stanley LaBounty dealer for more information.

WARRANTY

LaBounty® BLS Bucket Linkage Shears carry a limited warranty against defects in material and workmanship for 12 months or 1,500 hours from the date of purchase.

Stanley LaBounty reserves the right to repair or replace only those parts which prove to have been defective at the time of purchase.

Ask your Stanley LaBounty dealer to explain this warranty in detail.

Required **BLS 40** and **BLS 80**
Mounting and Pad Installation

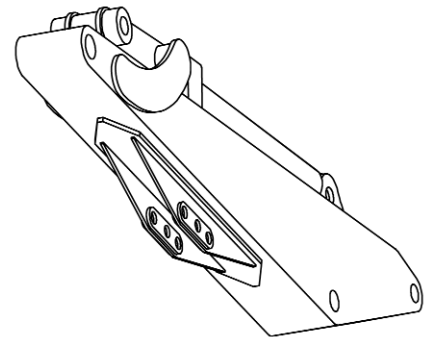

Note: Some excavator manufacturers may require stick reinforcement prior to mounting pad installation. Please consult with the original equipment manufacturer for details.

STANLEY

LaBounty

1538 Hwy. 2
Two Harbors, MN
55616 USA

Tel: 218-834-2123
Tel: 800-522-5059
Fax: 218-834-3879

email: labounty@stanleyworks.com
website: www.stanleyworks.com